



ZIRA

Pc Center  
Media Center

PC Center

Media Center

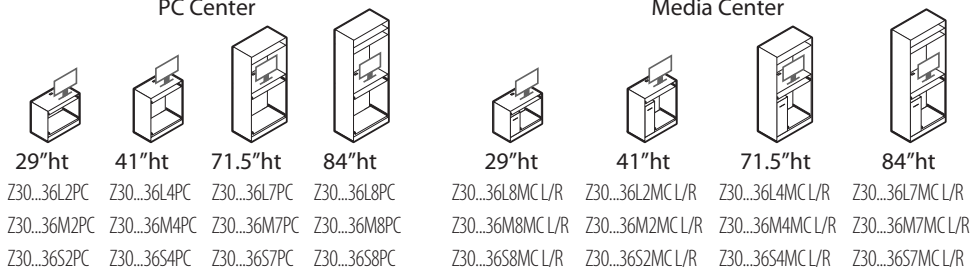

# Disassembly Instructions

## TOOLS REQUIRED



WRENCH  
Size #16 or 5/8"



ALLEN KEY  
Size #5



PHILLIPS  
Screwdriver size #2

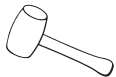

Rubber Mallet



Safety Glasses

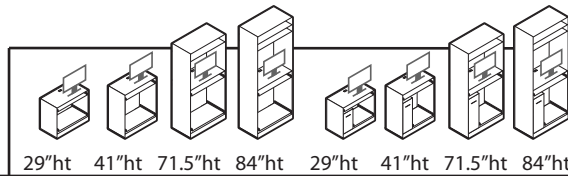
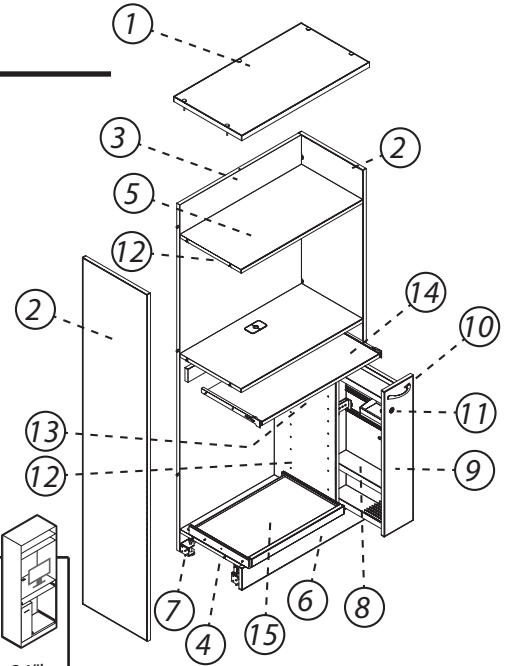

ITEM	DESCRIPTION	QUANTITIES								MATERIAL
		29"ht	41"ht	71.5"ht	84"ht	29"ht	41"ht	71.5"ht	84"ht	
1	TOP	1	1	1	1	1	1	1	1	PARTICLEBOARD
2	SIDE	2	2	2	2	2	2	2	2	PARTICLEBOARD
3	BACK	1	1	1	1	1	1	1	1	PARTICLEBOARD
4	BOTTOM	1	1	1	1	1	1	1	1	PARTICLEBOARD
5	SHELF			2	2			2	2	PARTICLEBOARD
6	KICKBASE	1	1	1	1	1	1	1	1	PARTICLEBOARD
7	CORNER BRACKET W/LEVELER	4	4	4	4	4	4	4	4	STEEL
8	VERTICAL DRAWER W/SHELVES					1	1	1	1	PARTICLEBOARD
9	VERTICAL DRAWER FRONT					1	1	1	1	PARTICLEBOARD
10	HANDLES					1	1	1	1	ALUMIUM
11	DRAWER LOCK MECHANISM					1	1	1	1	STEEL
12	SIDE DRAWER COVER					1	1	1	1	PARTICLEBOARD
13	TOP DRAWER COVER					1	1	1	1	PARTICLEBOARD
14	KEYBOARD SHELF	1	1	1	1	1	1	1	1	PARTICLEBOARD
15	PC/PRINTER SHELF	1	1	1	1	1	1	1	1	PARTICLEBOARD
16	SCREWS/BOLTS	65	65	79	86	115	115	128	134	STEEL

Please contact Global Customer Care at 905-660-5101 for any questions or concerns.

## STEPS

- A** For Media Center : Remove Drawer by Fully Extending and Disengaging latch on each slide while pulling drawer out.
- B** For Media Center :On Drawer boxes, unscrew and remove slide channels, handles and door lock mechanism. Untighten Minifix and Unscrew and remove, Shelves , side and back.
- C** Remove PC/Printer Shelf by Fully Extending and Disengaging latch on each slide while pulling shelf out. Remove Keyboard Shelf by Fully Extending, tilt the shelf and pull straight out.
- D** On PC/Printer Shelf, unscrew and remove slide channels, Untighten MiniFix Cam, release metal bar and remove plastic

- caps.On keyboard Shelf, unscrew and remove slide channels.
- E** Turn unit. Pull kickbase and unscrew kick base connector. Unscrew and remove corner brackets with leveler.
- F** Untighten Minifix Cam on top Drawer Cover. Unscrew remove side Drawer Cover.
- G** On Side Drawer Cover, unscrew and remove slide channels.
- H** Untighten Blum and Rafix Connectors.
- I** Unscrew Blum and Rafix Bolts. Unscrew and remove glide channels.

NOTE: Any alterations to listed components will void the manufacturer's warranty. The manufacturer will not be responsible for any damage or bodily harm caused by alterations in accordance with national or local electrical codes and manufacturer's specifications. In accordance with the manufacturer's policy of continual product improvement, the product presented in this document is subject to change without notice or obligation.

ZDIS 25 rev: 00

**E**

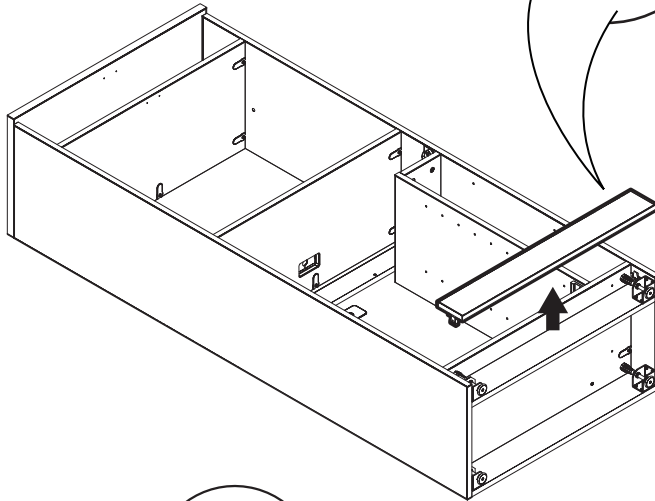
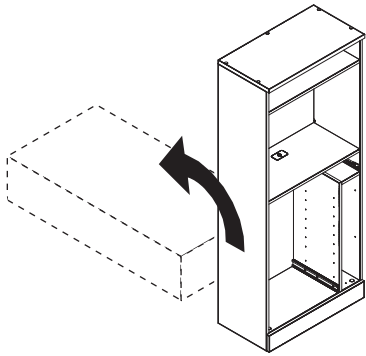

**F**

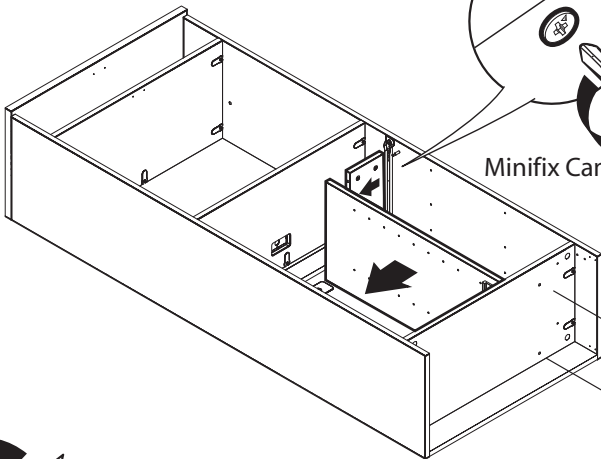

Minifix Cam

**G**

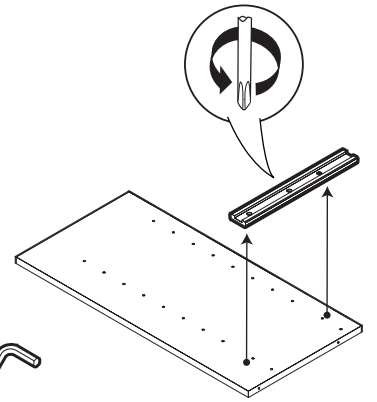

**H**

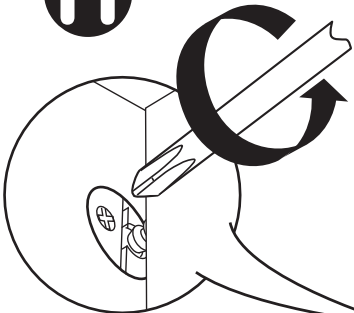

Blum Connector

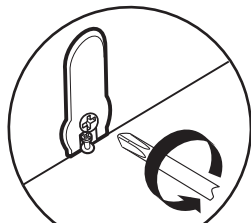

Rafix Connector

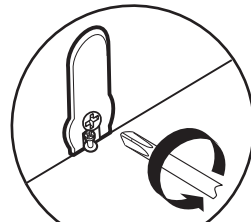

Rafix Connector

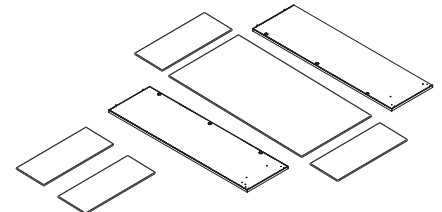
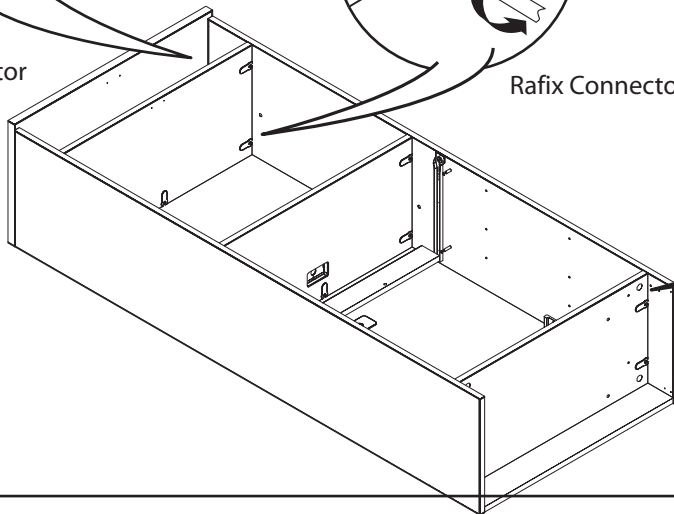

**A**

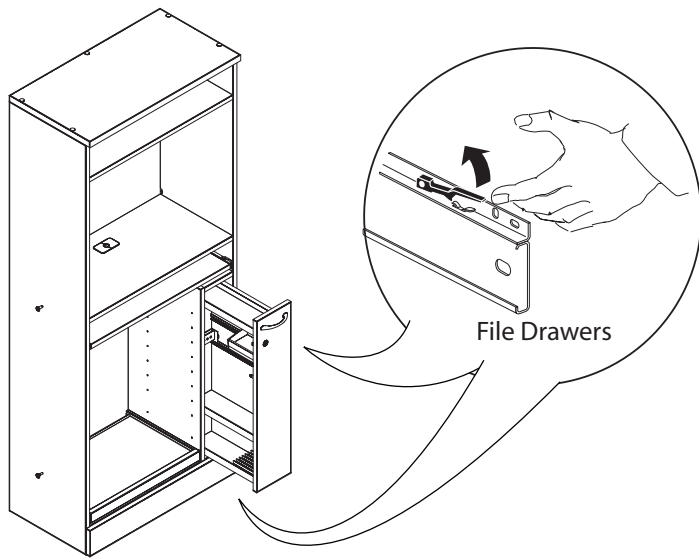

**B**

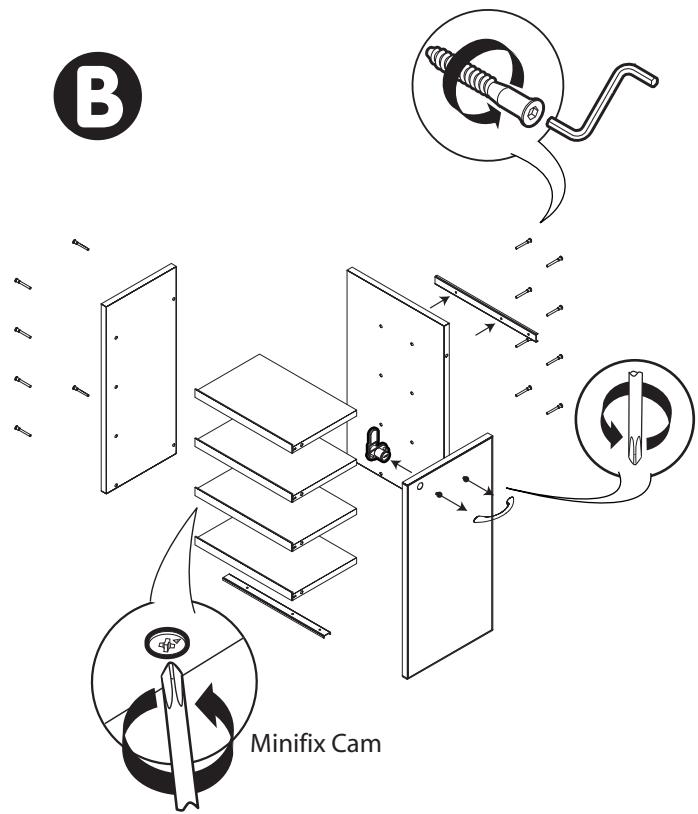

**C**

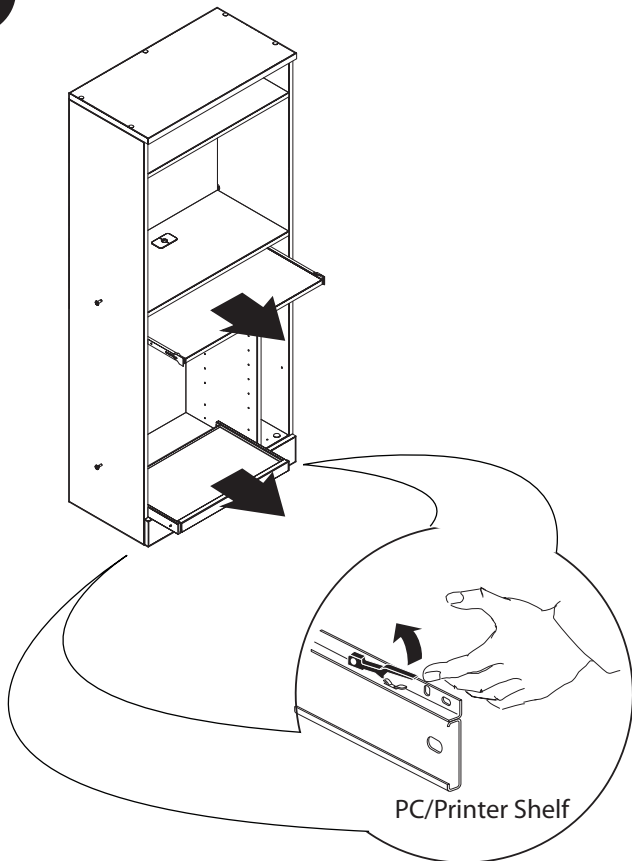

**D**

