

5H VERTICAL

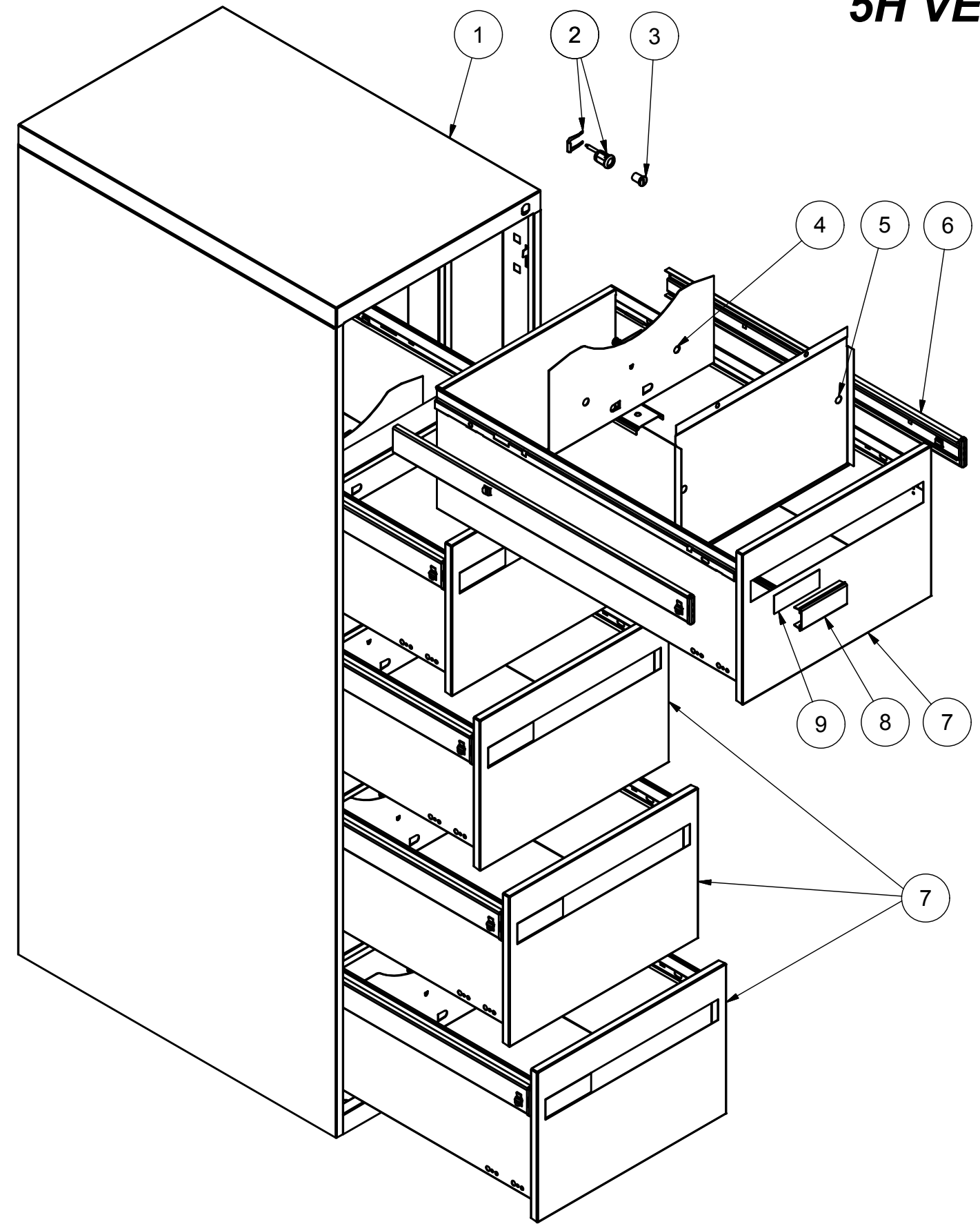

	Description	Qty	Material
1	Vertical case	1	Steel
2	Lock house + horseshoe clip	1	Steel
3	Lock core	1	Steel
4	Follower block	1	Steel
5	Inner front panel	1	Steel
6	Slide	Pair	Steel
7	Drawer body, Flush	5	Steel
8	Plastic card holder	5	Plastic (PVC)
9	Card	5	Cardboard

- TOOLS
- Googles
 - Robertson Screwdriver
 - Wrench
 - Rubber Mallet

DISASSEMBLY INSTRUCTIONS

- A.**
DISASSEMBLE THE DRAWERS
 Open the drawers (7) extend the slides (6) fully, tilt towards centre and lift
 These may need to be tapped with a hammer to release.
 Remove inner panel (5) follower block (4)
 and plastic card holder and cardboard card (8) (9) from each drawer
- B**
DISASSEMBLE THE CASE
 Remove the lock house and horseshoe clip (2) (3)